

C 132 - 73

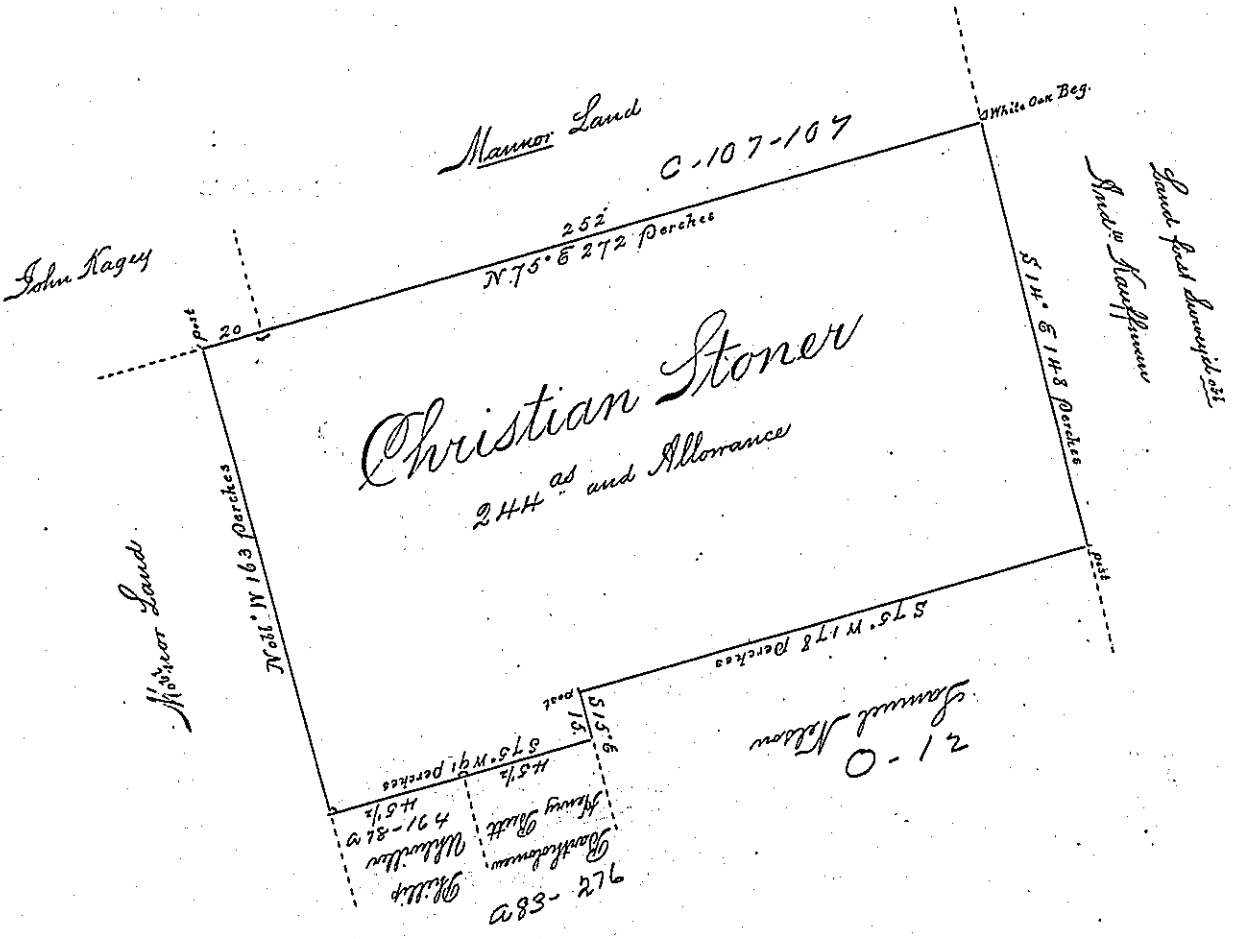

A Draught of a Tract of Land Situate in the Honourable the Proprietaries Mannor of  
 Conestogoe in Mannor Township Lancaster County Beginning at a marked White Oak in a  
 Line of Land Survey'd for Andrew Kauffman and therewith S 14° E 148 Perches to a Post a  
 corner of Land Survey'd for Samuel Nelson therewith S 75° W 178 Perches to a Post and S 15° E 15  
 Perches to a Post in x Nelson's Line thence Part with Land of Bartholomew Newry Drift and Part  
 with Land of Phillip Whlwiller S 75° W 91 Perches to a Post thence by a Line of marks Altered  
 Mannor Land N 15° W 163 Perches to a Post in a Line of Land Survey'd for John Nagay thence Part with  
 the same and part by a Line of Marked Trees and with Mannor Land N 75° E 272 Perches to the first men-  
 tioned White Oak and place of beginning containing Two hundred and forty four Acres and the Allow-  
 ance of Six Acres 10 Cent for Roads & Highways Survey'd the 23<sup>d</sup> June 1761 for Christian Stoner  
 To Nicholas Scull Esq<sup>r</sup> }  
 Surveyor General } p Geo Stevenson D.S.

IN TESTIMONY that the above is a copy of the original remaining on file in the Department of  
 Internal Affairs of Pennsylvania, made conformably to an Act of Assembly  
 approved the 16th day of February, 1833, I have hereunto set my Hand  
 and caused the Seal of said Department to be affixed at Harrisburg, this  
 Second day of February 1897.

James W. Fatta  
 Secretary of Internal Affairs.